

Airport and Aviation Services (Sri Lanka) Ltd

Airport and Aviation Services (Sri Lanka) Ltd. is a fully government owned company. It is one of the leading public business undertakings making a great contribution to the national economy and it is the institutional mechanism of the Government of Sri Lanka (GOSL) through which economic benefits of the civil aviation industry are channelled to the nation's coffers. The company is among the top most profit-making blue chip companies in Sri Lanka. It is actively involved in the national infrastructure development drive of the GOSL, especially in the field of aviation. The construction of the Southern International Airport at Mattala in the Hambantota district is one such mega project, which is currently on its public work schedule. The company has identified the need for doubling the handling capacity at Bandaranaike International Airport within the next five years and construction works necessary for such capacity enhancement are planned to commence in the near future. AASL is being transformed into a marketing oriented blue chip public company capable of withstanding competition and benefitting from competitive advantages. The company is planning to promote domestic aviation using the existing infrastructure of civil aerodromes scattered around the country and spreading its wings to cover the whole island.



Prasanna J Wickramasuriya www, rwp, rsp
CHAIRMAN



AYUBOWAN



Our Vision

To be the friendliest and best airport service provider in the Asia region.

Our Mission

To create competitively advantageous airport & aviation facilities and services to all users, and ensure stakeholder satisfaction.

The Runway is 3350 mtrs in length and has a full length parallel taxiway. It is equipped with modern navigational facilities. Both runway approaches are fitted out with Instrument Landing Systems. The Air Craft parking aprons have 24 parking stands. The Airport has an hourly capacity of approximately 25 aircraft movements.

The International Passenger Terminal Building which comprises of two sections on either side for Arrivals and Departures, has a total floor area of approximately 75000 sq. mtrs. It is capable of processing 6 million passengers per annum with a peak hour arrival or departure capacity of approximately 1400 passengers. A separate VIP facility is located between the Arrival and the Departure buildings.

Both Arrival and Departure terminals have undergone major expansion and refurbishment under the Phase II - Stage 01 Development Project. Expansion works consisting of one finger pier upon completion in year 2007 has brought the total number of aerobridge gates to 08 and 04 remote gates, 27 Immigration counters, 16 Emigration counters, 54 Check-in counters, 05 Arrival baggage belts, 03 Aprons having 24 commercial aircraft parking bays, sophisticated Radar, Visual Docking Guidance System etc.

BIA now has an annual handling capacity of 06 million passengers.



INFORMATION & HELP DESK

Desks located in the transit area, arrival & departure lobby areas provide information relating to flight or the airport facilities to visitors and passengers through friendly staff competent in multiple languages.

TRAVEL / TOUR SERVICE

Tour Operators & Hotel Counters located in the Arrival Lobby



PUBLIC TRANSPORT

A shuttle bus operates every 15 minutes from the terminal to the main bus stand located 500m away.



A TRANSIT HOTEL OPENS AT THE BIA

The newly constructed Transit Hotel Complex at Bandaranaike International Airport. It consists of 24 rooms categorized into four types depending on the facilities provided.



This service has been enriched with facilities of a conference hall and spa. Passengers who arrive at Bandaranaike International Airport can now relax in comfort, refresh themselves and continue their onward journey.

TAXI SERVICE

Airport Taxi service counter is located in the arrival lobby with a fleet of over 600 vehicles which operate to most cities.



BAGGAGE CLAIM

Flight Information television screens available for the allocation of the Baggage Claim Belt. Free trolleys are available near all baggage claim belts. 1st baggage arrival is within 18 minutes while the last baggage is expected within 40 minutes.



LOUNGES



"Silk Route" Lounge

The new "Silk Route" Lounge - an exclusive pathway that will provide a smooth and hassle-free entrance for commercially important passengers (CIPs) is available at the arrival Terminal of BIA. Guests of the lounge will have the opportunity to relax in luxury and comfort and will be provided with exclusive and expedited airport formalities.

Whether you are a business or a leisure passenger enjoy the sanctuary of exclusive lounges in the transit area, which offers a wide range of facilities.

Executive Lounge For special passengers

Araliya Lounge For Business Class passengers

Lotus Lounge For First Class passengers

Serandib Lounge For Sri Lankan Airlines First Class & Business Class passengers



CURRENCY EXCHANGE

Banking facilities are available in the arrival & departure lobbies.

DUTY FREE SHOPPING

Plenty of shops are available at the transit and arrival area offering a diverse range of quality products. The shops are carefully designed in an open free-flow concept, creating an informal and relaxed environment for passengers to browse and shop.



COMMUNICATION



Counters are available in arrival & departure Lobbies and transit area with Internet, IDD, E-mail and fax facilities. Mobile phone connections can be obtained from major company outlets located in the arrival lobby.

AIRLINE TICKETING

Sri Lankan Airlines Ticket office is located in the departure porch.



RESTAURANTS



Restaurants are available in the public areas, Departure Lobby and transit area serving local and international cuisines. A Coffee café and a bar that serves cocktails, wines and spirits are also available in the transit area.

PUBLIC VIEWING GALLERY (PVG)

A viewing gallery is open 24 hours to facilitate the requirements of airport visitors. Restaurants, shops, sanitary amenities, information, aviation exhibits, display of an aircraft are among the facilities available at PVG of BIA.



VIP LOUNGE



LANDSCAPING

The external landscaping has a natural and tropical effect with colourful tropical plants and stretches of turf to compliment a green and natural environment. Waterfalls at major landscaped areas and ponds provide relaxing respite for visitors.



AIRLINES OPERATING

Air Arabia
Air Asia
Air India
Air India Express
Cathay Pacific Airlines
Condor Airlines
Emirates
Island Aviation
Jet Airways
Jetlite
Kingfisher
Kuwait Airways
Malaysian Airlines
Meridiana fly
Mihin Lanka
Oman Airways
Qatar Airways
Royal Jordanian Airlines
Saudi Arabian Airlines
Singapore Airlines
SriLankan Airlines
Thai Airways
Thomson Airways
Travel Service

AIR NETWORK

Scheduled Airlines	25
Cities	47
Countries	22
Weekly Scheduled Flights	574

The passenger, cargo and aircraft movements at BIA are as follows:

	1983	1987	1991	1995	1999	2003	2007	2009
Passengers (millions)	1.22	1.12	1.52	2.23	2.64	3.23	4.89	4.2
Aircraft (Nos.)	15433	15901	18110	19495	27130	27937	42878	37651
Cargo (Mt)	22329	28130	43559	76312	102708	124528	163570	138684

RECENTLY COMPLETED PROJECTS

- Transit Hotel complex with 24 rooms and a spa

ONGOING DEVELOPEMENTS AT BIA

- Expansion of transit shopping area.

PLANNED DEVELOPEMENTS FOR BIA

BIA is currently planning its developments under Phase II - Stage 02 Development Project to be completed by 2014. Upon completion of the project, BIA will have;

- A handling capacity of 12 Mn Passengers per annum.
- A multi level Terminal
- An elevated roadway system
- A new pier with 08 gates compatible with A-380 air bus standards
- A new apron with 14 parking slots.
- Additional immigration and customs counters
- Multi storied car park
- New public utilities including power supply system, water supply system sewage treatment system and solid waste disposal system
- Modern baggage belts for baggage handling
- Modern Flight Information Display system (FIDS)
- Automated security gate system

A luxury railway system between Colombo and BIA to facilitate access for passengers & visitors.

HAMBANTOTA INTERNATIONAL AIRPORT

The Government's Manifesto contained in "Mahinda Chintana" – Randora emphasizes the establishment of a second international airport in Sri Lanka while pursuing action to develop 13 existing domestic airstrips, thereby providing the Nation with a modern air transport network that will support the enormous development activity envisaged within the next five years.

The primary function of the second international airport is to support the mega development activities taking place in the southern region of the country specifically the Hambantota District Development Initiative. This initiative consists of the development of an International Convention Centre, the Hambantota Sea port, an Administrative Complex, an Oil Refinery and other similar commercial initiatives.

Sustainable development is the most crucial element in the creation of this airport. We believe, sustainable development can be achieved by creating the intricate balance between the environment, society and the economy. This is the credo the airport development programme will follow.

Objectives

- To play a vital and supportive role in the development activity in the Hambantota region to capture market share of the regional traffic growth.
- To be a key component in the development efforts of the East and Southern coasts
- To be an alternate airport to BIA, offering tremendous fuel / weight savings to airlines, resulting in increased passenger / cargo volume to the country.
- To facilitate the establishment of a gateway for economic and investment infusion into Sri Lanka.
- Eradicate poverty of regions through enhancement of economic activity in the region.
- Enhanced living conditions of inhabitants.

The Project Brief

Summarized version of the project is as follows :-

- Estimated Project cost – US\$ 210,000,000 (US Dollars Two hundred and ten million).
- Airfield capacity - Annual service volume of proposed aerodrome is expected to be 30,000 operations with enhancement capability.
- Extent of land - 2000 hectares in total. Initial construction limits to 800 hectares.
- Aerodrome design - The aerodrome will be designed to meet the ICAO specifications for Code 4F
- Runway length is proposed as 3500 m and the width is proposed as 75 m
- Taxiways - Recommend having a 370m long sub taxiways from the runway centre line to the edge of the apron. Taxiways compliance to ICAO Code F&C
- Apron - 10 (ten) parking positions will be provided,
- Passenger Terminal - Size of which is proposed to be 10,000sq. m. to accommodate 400 peak hours and 100 domestic passengers two ways with in line baggage handling system.
- Cargo Terminal Building – 5000 sq.m of cargo terminal with handling capacity of 50,000 metric tons.
- Category 10 Fire & Rescue Services with 1500 sq.m office areas.
- Radar & Control Operations – Control Tower to 40m height with Navigational Complex and Meteorological Station.

Opportunities for Commercial entities and Stakeholders



Materializing a Second International Airport in Sri Lanka from concept to reality is the driving force behind this project. The successful conclusion of this project will highlight the Government's effort to increase the economic development and investment strategy of the Greater Hambantota Development initiative as well as the nation at large, through "Randora", a programme initiated by the National Infrastructure Development programme which comes under "Mahinda Chintana".

As a Company, Airport & Aviation Services (Sri Lanka) Ltd., (AASL) is committed in its effort to achieve this goal through effective corporate governance, fairness and integrity.

We strongly believe this Project will achieve stability through financial and operational performances.

DEVELOPMENT OF PHASE II STAGE 2 OF BIA

The Government of the Democratic Socialist Republic of Sri Lanka intends to proceed with the Bandaranaike International Airport Development Project Phase II Stage 2. The Project aims to construct a new passenger terminal facility to accommodate the increasing number of air passenger traffic at the present passenger terminal building which is expected to reach design capacity by 2010.

Airport and Aviation Services (Sri Lanka) Limited, the executing agency, carried out a Feasibility Study in 2006 through Japan Airport Consultants and has requested an ODA loan from the Japanese Government based on the result of the study. AASL appointed a design consultant in October 2008 to carry out the design works and preparation of tender documents for the project.

Scope of the Project

- Construction of New Passenger Terminal Building including a pier
- Construction of Elevated Roadway and Roads
- Construction of Remote Apron and Taxiways
- Construction of Public Utilities including Power Supply System, Water Supply System, Sewage Treatment System and Solid Waste Disposal System

Demand Forecast

	2007	2015	2020	2025
Annual Passenger	4,898,891	8,175,000	11,007,000	14,691,000
(Sri Lankan)	2,869,999	5,015,500	6,979,000	9,587,000
(Foreign Passenger)	988,016	1,564,500	1,946,000	2,411,000
(Transfer/Transit)	1,040,876	1,595,000	2,082,000	2,693,000
Peak-day Passengers		25,900	34,800	46,500
Peak-hour Passengers (one way)		1,890	2,300	2,830
Annual Operation		51,000	64,900	80,500

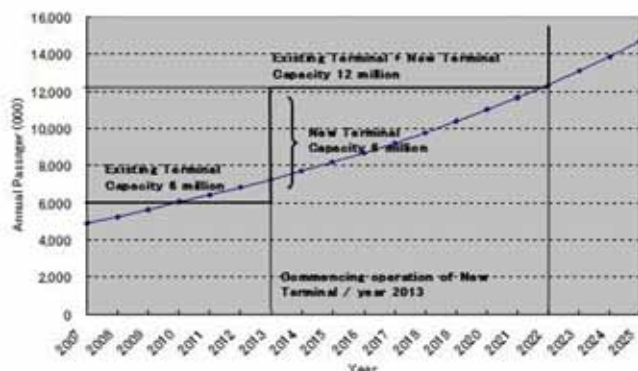
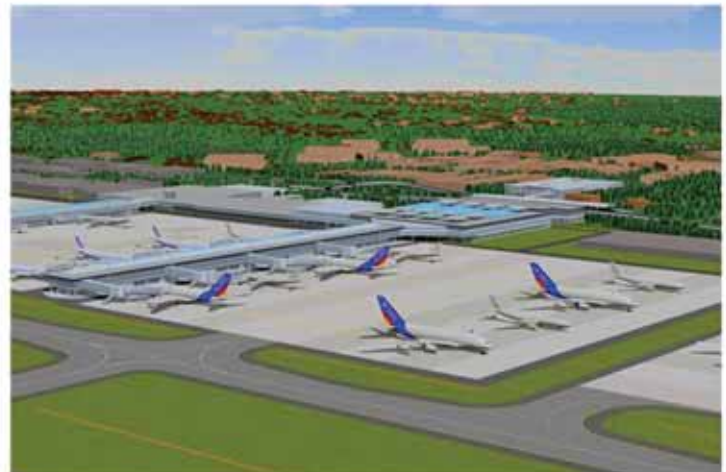

Development Concept of Phase II Stage 2

Commencing Operation	Year 2015
Target Year	Year 2022
Target Capacity	12 million passengers
	Existing Terminal : 6 million passengers New Terminal : 6 million passengers

Terminal Layout Plan of Phase II Stage 2

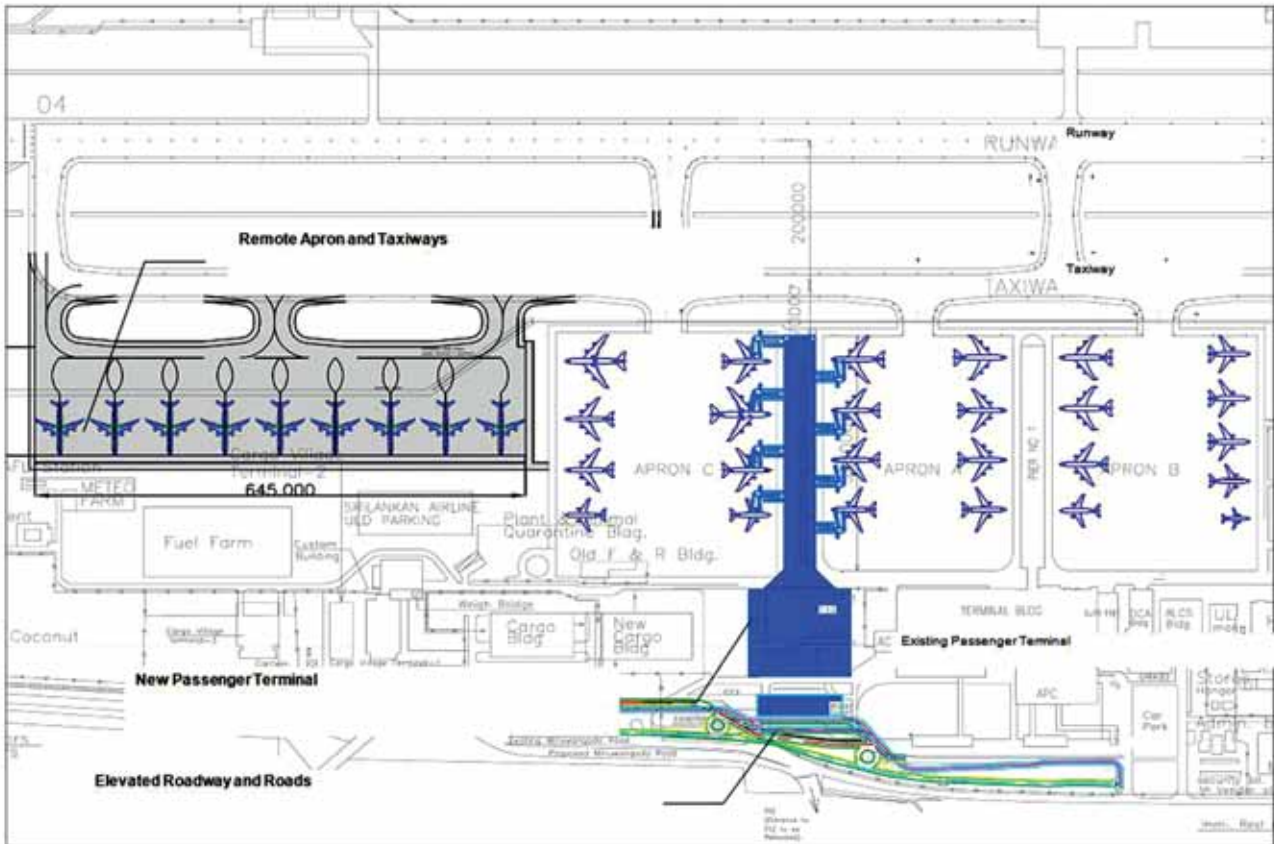

New Passenger Terminal Building

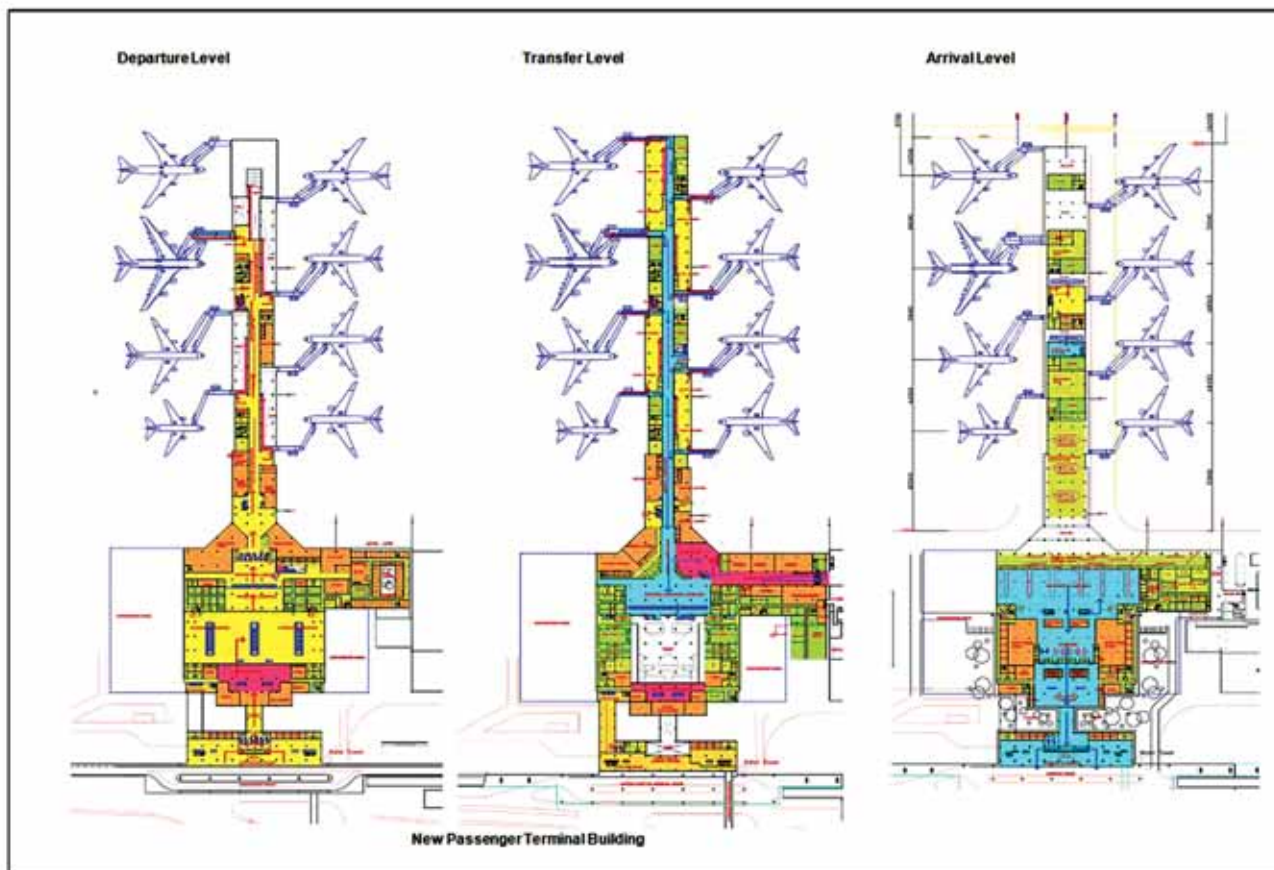

Airport & Aviation Services (Sri Lanka) Limited
Bandaranaike International Airport
Katunayake



2011
HAMBANTOTA
INTERNATIONAL AIRPORT